



contact **mini**

Digitales Knochenleitungshörsystem

Digital bone conduction hearing system

- Binaural
- Monaural

Gebrauchsanweisung / User Instruction

Many thanks for choosing a quality product from BHM-Tech. The digital bone conduction hearing system contact mini is manufactured in Austria in accordance with provisions set by the European Medical Device Directive 93/42/EEC, and is in line with the latest audiological findings and technical innovations. It bears the CE mark, signalling its adherence to the latest quality and safety requirements.

Intended Use: The bone-conduction hearing system contact mini is intended to compensate hearing impairment by processing and amplifying the sound and transferring it to the inner ear.

Users: The hearing system is intended to be used by young children, even babies, and adults.

Indications: For mild to moderate hearing loss.

Contraindications: Irritated skin or pressure marks possible.

Your contact mini has been selected for you by your hearing aid acoustician or ENT-doctor according to your hearing impairment and has been adapted to your needs. Your hearing aid acoustician/doctor will provide you with comprehensive instruction on first-time use, proper handling and regular maintenance measures.

Content

| | |
|--|----|
| Hearing system components | 23 |
| Operation | 24 |
| Sound Dynamix (BHM Automatic  | 26 |
| Adjustment and programming | 32 |
| If your hearing system doesn't work..... | 33 |
| Instructions for cleaning your hearing system... | 34 |
| Important information | 35 |
| Service & Repair | 37 |

PLEASE READ THIS USER INSTRUCTION CAREFULLY BEFORE USING YOUR DEVICE.

IF YOU WILL NOT BE WEARING THE HEARING SYSTEM YOURSELF, PLEASE TAKE NOTE OF THE FOLLOWING INFORMATION AS RELATES TO THE PERSON WHO WILL.

Please check that the device functions safely and is in proper condition before use. The device must under no circumstances be used if there is any suspicion that it does not work flawlessly or is damaged.

Do not place any excessive mechanical strain on your device. Should it be dropped on the ground or otherwise damaged, please send it to your hearing aid acoustician/doctor for checking and repair.

Never give your bone conduction hearing system to others i.e. please prevent unauthorised use.

Description

The monaural bone conduction hearing system contact mini consists of one electronic part and one bone conduction receiver (see Figure 1).

The binaural bone conduction hearing system contact mini consists of two electronic parts and two bone conduction receiver (see Figure 1).

Registered design
No.: AT 010 553 U1

Hearing system components

- ① Bone conduction receiver
- ② Battery compartment
- ③ Battery size 13
- ④ Child lock
- ⑤ Microphone port
- ⑥ Volume control
- ⑦ Programming socket – below socket cover
- ⑧ Safety cap
- ⑨ Cable

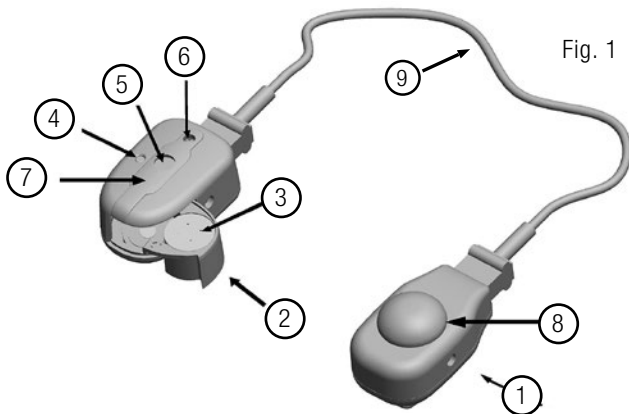

Fig. 1

| Technical Data according to DIN IEC 118-9 | |
|---|----------------------|
| max. acoust.-mech. Sensitivity (dB) | 51 |
| max. Output-Force Level (dBOFL) | 114 |
| current consumption (mA) | 1.06 +-10% @1.35V |
| battery size | 13 |
| battery life (@ 290mAh battery capacity) | approx. 270h |

Operation

Note: Your doctor or hearing aid acoustician will decide which wearing system is the most suitable for your contact mini.

Your doctor or hearing aid acoustician will provide you with full instructions on how to use your contact mini and accessories.

IN ORDER TO GUARANTEE THE SAFETY AND FUNCTIONALITY OF THE HEARING SYSTEM, ONLY ACCESSORIES FROM BHM-TECH MUST BE USED.

1. Cable connection

Insert the polarised plug of the cable into the electronic component and the other polarised plug into the bone conduction receiver.

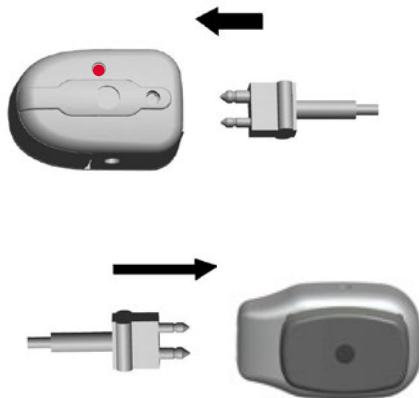

2. Opening the battery compartment and inserting the battery

To open the battery compartment in order to insert or change the battery, press the red child-safety button with the reverse end of screwdriver no. 1.

Please make sure that the battery is inserted correctly i.e. the terminals are correctly aligned. (Please note the + and - markings on the battery.) Close the battery compartment carefully with your fingers until the child lock is activated.



The contact mini hearing system has no ON/OFF switch. The device is switched off by opening the battery compartment. We recommend storing your device in a safe place after daily use, with the battery compartment open. Opening the battery compartment also enables you to dry residual moisture.

Note: Before inserting the battery, it is imperative to wait for 15 seconds after removing any adhesive tape on the battery.

Battery

Always use high-quality size 13 batteries. Your doctor or hearing aid acoustician will be pleased to advise you in this regard.

If the hearing system is not in use, please open the battery compartment. Store it without battery and out of reach of children, ideally in a drybox. (see on page 35)

Battery warning tone

contact mini is equipped with a battery warning tone. When the battery is weak, amplification will automatically be reduced. When the warning tone sounds, the battery must be changed immediately.

Sound Dynamix (BHM Automatic)

In Automatic mode, the signal received by the microphone is analysed and categorised into different hearing situations.

These are:

- Quiet environments
- Speech in quiet environments
- Speech in background noise
- Music and movie
- Background noises
- Wind noises

The parameters of the hearing system are always configured according to this categorisation such that an optimal level of hearing comfort and optimal speech comprehension are attained.

Switching to telecoil – Optional (only for contact mini with telecoil)

You can let your contact mini be upgraded with the telephone-coil-mode "inductive signal reception". Please contact your hearing-aid-acoustician or ENT-doctor.

In order to switch the device, set the M-T switch to the "T" position. The telecoil enables you to receive inductive signals (e.g. from the telephone or induction loop). This enables you, for example, to hear the person on the other end of the line more clearly, as the microphone is switched off and disruptive background noises are therefore prevented.



Please note that you must use a phone that is suitable for a hearing device in order to make optimum use of the telecoil. The telecoil can also be used in public buildings that have an induction loop, for example in schools, theatres, concert halls or cinemas. It is also possible to select a combined microphone/telecoil mode using the fitting software. This mode enables you to receive inductive signals whilst also hearing your environment better as the microphone is switched on. The device is supplied with the combined mode M/T.

3. Setting the volume

Adjust the volume of the contact mini by turning the blade of screwdriver no. 1 on the volume control (electronic component). Please consult your doctor or hearing aid acoustician about the ideal volume for you. Please ensure that you are properly informed by your doctor or hearing aid acoustician

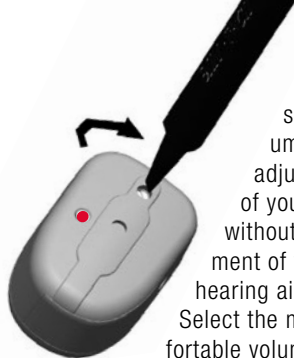

as regards setting the volume, and do not adjust the volume of your contact mini without the agreement of your doctor or hearing aid acoustician. Select the most comfortable volume for you by rotating the volume control. The volume will become louder by turning it clockwise, or quieter by turning it anti-clockwise.

Please note:

Please make absolutely sure that your contact mini wearing system is positioned correctly on the head and that the conductor plate of the bone conduction receiver rests against the head. Please make sure that the conductor plate is touching the skin.

- Hair between the conductor plate and the skin may reduce transmission considerably.
- Poor contact with the skin and a high volume may cause feedback.

4. **Attaching the contact mini to the wearing system**

Both the electronic component and the bone conduction receiver are fitted with snap-on fastener, which facilitate attachment to the selected wearing system, for example a headband soft or headband plastic.

CAUTION: In particular for babies, please ensure that the wearing system is repositioned at regular intervals due to the infant's soft cranial bones. Your doctor or hearing aid acoustician will provide instructions.

Assembling/disassembling components

1. Electronic

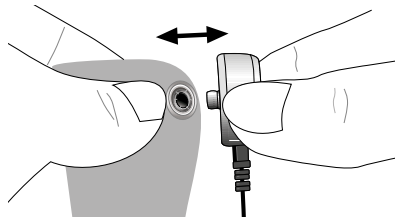

2. Bone conduction receiver

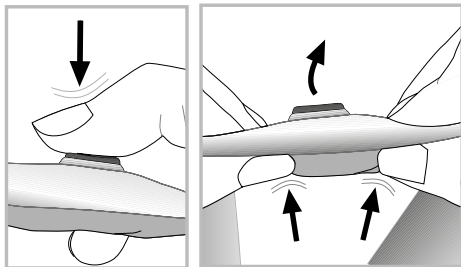

Always make sure that the electronic component is mounted away from the head at the front; and that the bone conduction receiver is mounted towards the head at the back. Improper assembly may cause the contact mini to malfunction.

Attaching the electronic component and the bone conduction receiver to a headband plastic or headband soft.

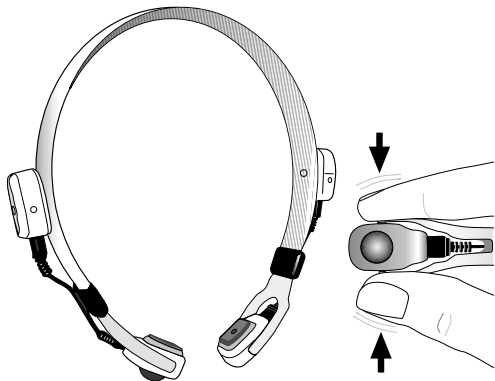

When using a headband plastic, the snap-on fastener on the bone conduction receiver loses its function and is covered by the safety cap supplied upon delivery (8).

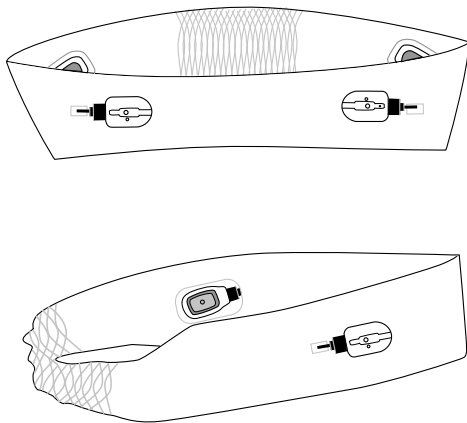

Bending the headband plastic

In order to ensure an optimum fit when using the headband plastic, we recommend bending the headband plastic as required. Please follow the instructions step by step, as shown in the diagrams.

Warning: Risk of scalding – please keep children away from this process!

- 1) First remove the electronic component, bone conduction receiver and cable from the headband plastic. Then dip the headband plastic into a suitable container filled with hot water for approx. 4 minutes, as shown in Figure 2 (80 degrees Celsius). Please make sure that the rubber mounting for the cable does not come into contact with the water.
- 2) Bend the headband plastic according to your requirements i.e. to fit the required head shape.

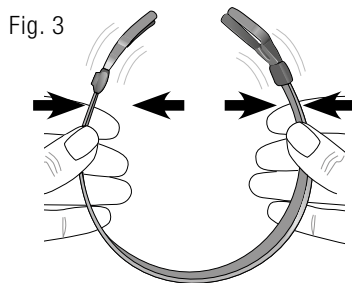
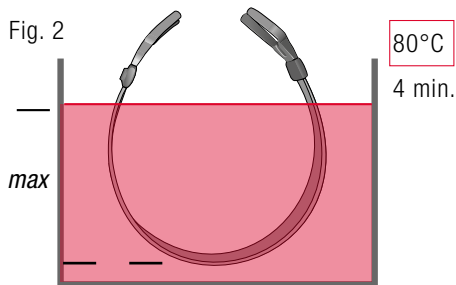
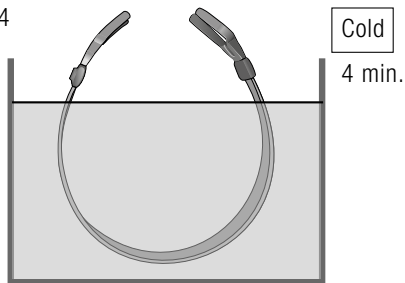

Fig. 4



3) Hold the headband plastic in the desired shape and dip it in cold water for approx. 4 minutes.

4) Now reattach the electronic component, bone conduction receiver and cable to the headband plastic.

Cleaning your headband plastic

Please make sure that the electronic component and bone conduction receiver have

been removed before cleaning the headband plastic. Sweat and moisture should be wiped away on a daily basis with a damp cloth, and then wiped down with a dry cloth.

Cleaning your headband soft

Please make sure that the electronic component, bone conduction receiver and cable have been removed before cleaning the headband soft. For more precise cleaning instructions, please refer to the information on the headband soft label.

Adjustment and programming

(Only for your doctor or hearing aid acoustician)

IMPORTANT INFORMATION:

The contact mini hearing system is available as a binaural or monaural hearing system. Your doctor or hearing aid acoustician will decide which device is worn on the left and which is worn on the right during the programming process. In order to label the device clearly and to attach it to the wearing system, please assemble the colour rings supplied onto the electronic casing snap-on fastener as follows:

Blue/red ring:

Left/right device as the patient sees.

Note: The colour rings must be attached, as these also serve to dampen vibration.

5. Before programming: removing the casing cover

Open the battery compartment, as described in Point 2. open the cover lock using screwdriver blade no. 1 and then carefully lift up the cover. The programming socket will now be visible. Insert the programming cable plug into the socket.



Note: Please ensure that the red marking on the programming cable plug is on the same

side as the yellow marking on the programming socket. There will be no connection otherwise!

6. Fitting software

In order to guarantee flawless function, please only use the BHM-Tech software released for this product. If you have any doubts or queries, please contact your supplier or BHM-Tech.

7. After programming

Remove the programming cable and assemble the cover as described.

- Slide the cover carefully into the casing.
- Carefully press the cover back into the casing.

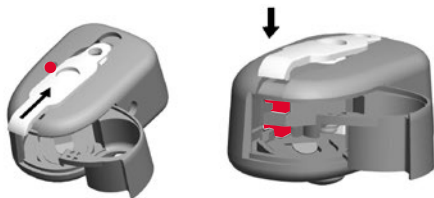

Recommendation: If you wish to switch off the volume control function, you can do so by deactivating it using the fitting software.

If your hearing system doesn't work

- Please note that your hearing system will automatically switch off when the battery is low.
- Please check that your hearing system is connected by cable and that the battery compartment has a battery inside and is closed properly.
- Does the battery have enough power and has it been inserted correctly? Please make sure that you always carry replacement batteries with you. Use a new battery from the packaging.
- Has the volume control been adjusted correctly? Make sure that the bone conduction

- receiver is correctly positioned on your head.
- Background noise and noise signals may not necessarily indicate a fault or error in the hearing system – this may be interference from mobile phones or other electronic devices in your vicinity.
 - If your hearing system still does not work after checking all the above points, please take your device to your doctor or hearing aid acoustician with a concise description of the error.

Instructions for cleaning your hearing system

In order to ensure the guarantee and warranty of your hearing system, we suggest cleaning your hearing system thoroughly and properly at least once a day. Wipe your hearing device with a clean, dry cloth and make sure that your fingers are clean and dry too.

Remove any sweat and moisture from your hearing device. It is also necessary to remove the battery from your hearing device every evening after cleaning, and to store it overnight with the battery compartment open in order for any moisture to evaporate. Please remove your hearing device before showering, bathing or visiting a sauna and before using body care products, hairspray or cosmetic powder, as these kinds of deposits contaminate your hearing device and may impair or damage its function.

To ensure proper cleaning and to preserve perfect service, BHM recommends the use of a drybox. Simply put your hearing aid in the drybox and switch it on. Within 2 hours your device will be clean and ready for use (see page 35).

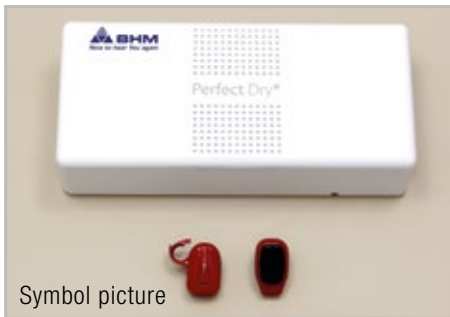

Important information

The basic settings of your hearing system are put in place by authorised experts according to the particular hearing loss at hand. The user must therefore only use the easily accessible operator elements intended for him or her, as per instructions.

WARNING! Improper use of your hearing system and batteries may endanger your health. Please read the following points with great care.

- Keep other people including children away from your contact mini hearing system and its parts.
- Adjust the volume according to individual requirements and upon instruction by your doctor or hearing aid acoustician.
- This hearing system is able to emit signals at a very high volume. In order to prevent possible hearing damage, the hearing system must be adapted by a qualified hearing aid acoustician.

- Never try to charge disposable batteries in the charger!
 - Swallowing batteries endangers health and can cause serious injury and even death. Therefore: Never store batteries alongside medication. Please seek immediate medical attention in the event of swallowing a battery.
 - Improper handling of the hearing system may loosen the smallest components of the hearing system.
 - Never expose your hearing system to extreme solar irradiation (for example on your car windshield), extreme heat (do not place on heating devices) or extreme cold (overnight in a cold car) and avoid contact with chemicals or harsh detergents.
 - Please always be aware that hearing systems will no longer function properly if, for example, battery power is running out. This poses a particular danger in traffic or when you are in any other way dependent on warning signals.
- Switch your hearing system off in mines or in places areas exposed to explosion hazards, unless it has been specially approved for this purpose.
 - Never replace your hearing system's batteries when you are with infants and children.
 - Sweat and moisture should be removed from your hearing system on a daily basis (wipe with a dry cloth). Please remove your hearing system before showering, washing your hair, stepping into a sauna or steam bath.
 - Consult a doctor if skin irritation occurs.
 - **Swallowing the battery bears the highest risks when wearing a hearing aid! It is indispensable to keep them out of reach of children!**

Further important information!

- Your hearing system plus accessories and batteries is a modern technology product that must be responsibly disposed of within the scope of environmental protection. As

such, please take these items to a special disposal site. Your hearing aid adviser will be happy to help you in this.

- For particularly hygienic and mild cleaning, we recommend special products available from specialist stores. Under no circumstances use petrol or similar chemical cleaning products.
- A faulty hearing system must be repaired by a specialist. Do not try to open the device yourself. Improper handling will result in the guarantee becoming void. If your hearing system is defective, please consult your hearing aid acoustician. Regular maintenance

and checking with your hearing aid acoustician can prevent repairs.

- In the case of interference fields with electro-magnetic interference such as transmitters, the hearing quality of your hearing system may be impaired.

Service & Repair

If your hearing system does not work, it must be repaired by a qualified service technician. Do not try to open the hearing system casing, as this will void the guarantee and warranty for the hearing system. Please contact your hearing aid acoustician/doctor if your hearing system needs repair.



BHM-Tech Produktionsgesellschaft mbH
Grafenschachen 242
7423 Grafenschachen, Austria
www.bhm-tech.at



0297

nach EU-Richtlinie 93/42/EWG

Qualitätsmanagementsystem nach DIN EN ISO 13485

According to EU directive 93/42/EEC

Quality management system according to DIN EN ISO 13485

